

CERTAIN 2020 MODEL YEAR MUSTANG GT500 AND GT350 VEHICLES EQUIPPED WITH A 5.2L ENGINE — SECONDARY TIMING CHAIN TENSIONER

Table Of Contents

Mobile / Dealership Inspection.....	1
Service Procedure.....	4

MOBILE / DEALERSHIP INSPECTION

1. Remove the oil fill cap. See Figure 1.

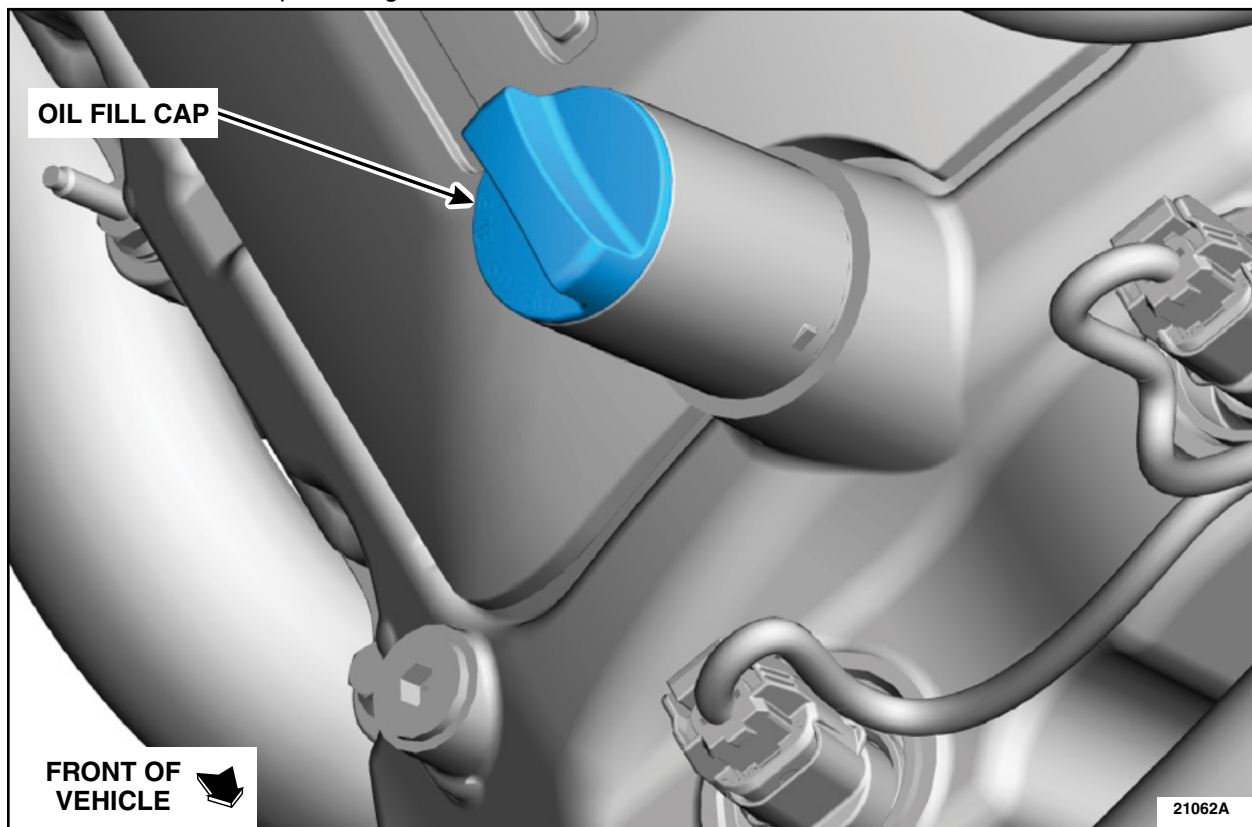

FIGURE 1



2. Inspect the Right Hand (RH) secondary timing chain tensioner for activation. The RH secondary timing chain tensioner is inspected through the oil fill opening using a mirror and when activated will show the groove in the shaft of the tensioner. See Figures 2 and 3. Is the groove on the RH secondary timing chain tensioner visible?

If YES - Install the oil fill cap. This recall does not apply to this vehicle.

If NO - Proceed to Step 3.

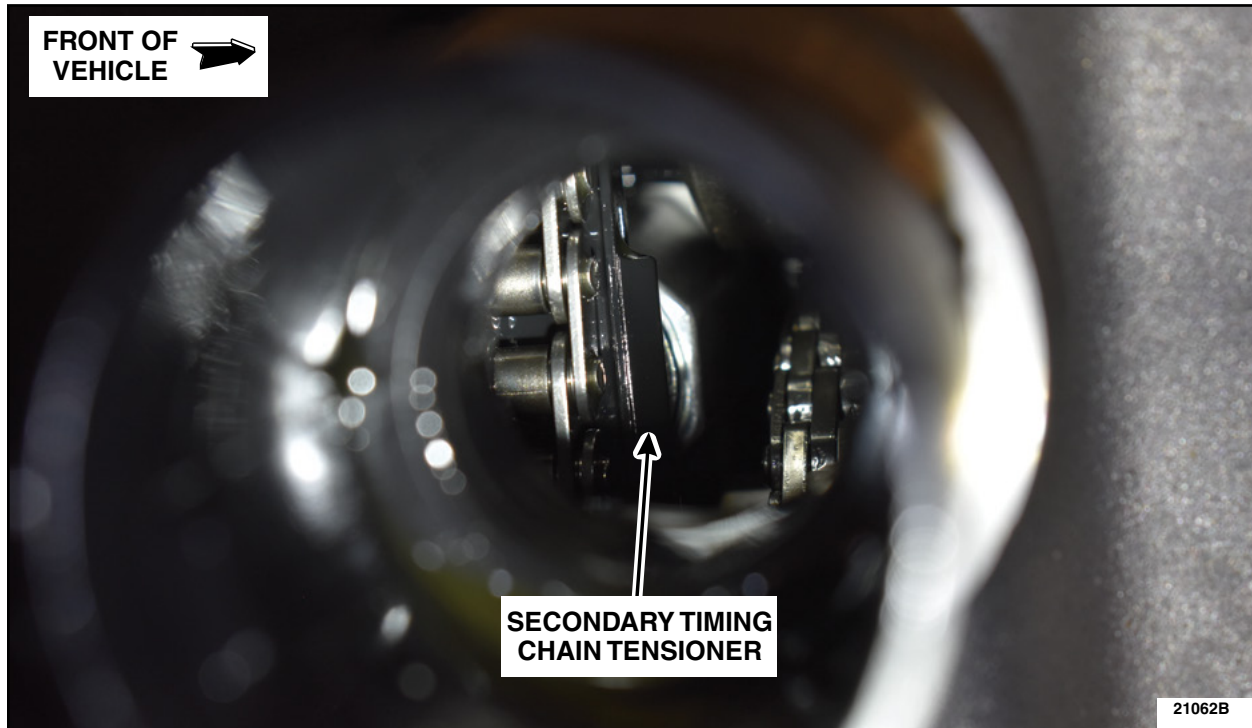

FIGURE 2

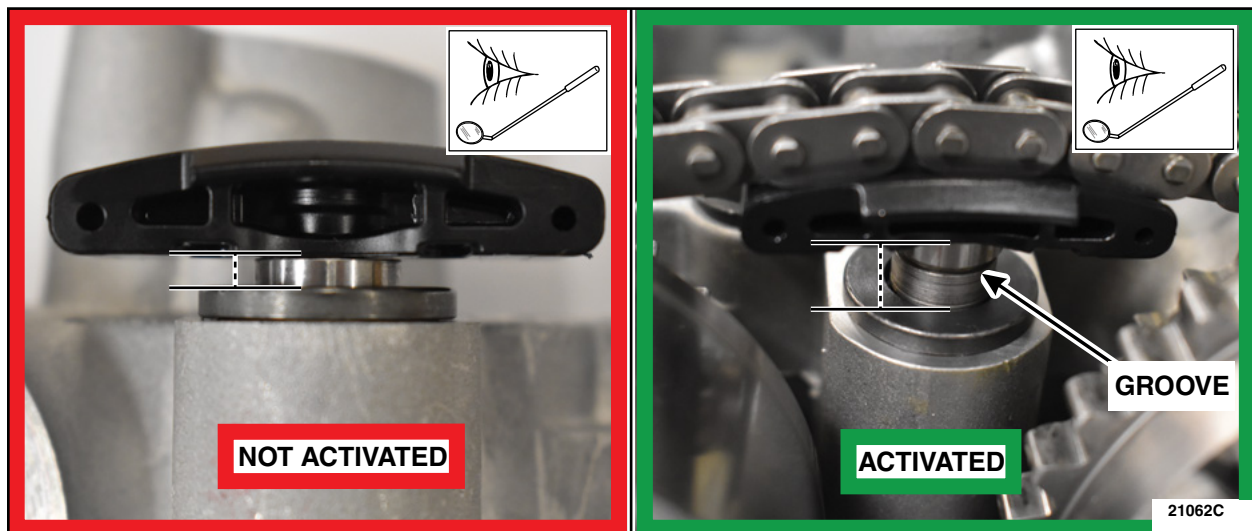

FIGURE 3



NOTE: Do not disconnect any of the coolant hoses.

3. Remove the retainers and position aside the degas bottle. See Figure 4.

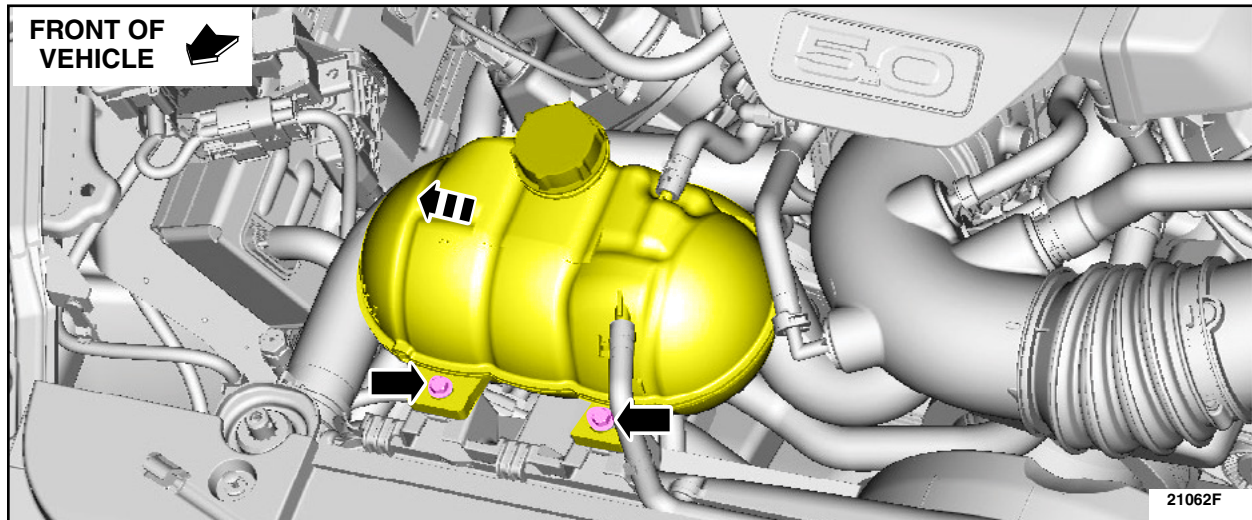

FIGURE 4

4. Rotate the engine from the 12 o'clock position to the 8:30 position and reinspect the secondary timing chain tensioner. See Figures 2 and 3. Is the groove on the secondary timing chain tensioner visible after rotating the engine?

If YES - Proceed to Step 5.

If NO - For Mobile Inspection: Contact the SSSC. Vehicle will need to be towed to the dealership for repair.

- For Dealer Inspection: Proceed to the Service Procedure on Page 4.

5. Position back the degas bottle and install the retainers. See Figure 4.

- Torque: 80 lb.in (9 Nm)

6. Install the oil fill cap. See Figure 1. This recall does not apply to this vehicle.



SERVICE PROCEDURE

NOTE: Proceed with the Service Procedure only after a vehicle has failed Inspection.

1. Remove the valve covers. Please follow the Workshop Manual (WSM) procedures in Section 303-01.
2. Using the crank bolt, rotate the engine until the single blue timing link is aligned to the timing mark on the exhaust VCT. See Figure 5.

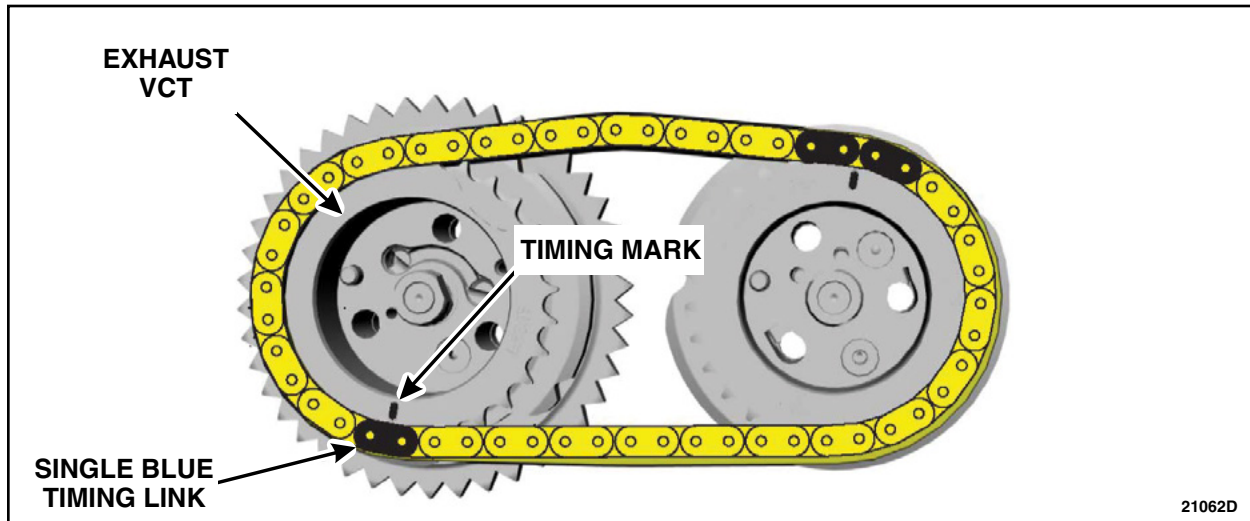

FIGURE 5

3. Check the timing on both the RH and LH secondary timing chain. Is the intake VCT timing mark between the double blue timing link? See Figure 6.

If YES for BOTH sides - Proceed to Step 7.

If NO for ONE or BOTH sides - Proceed to Step 4.

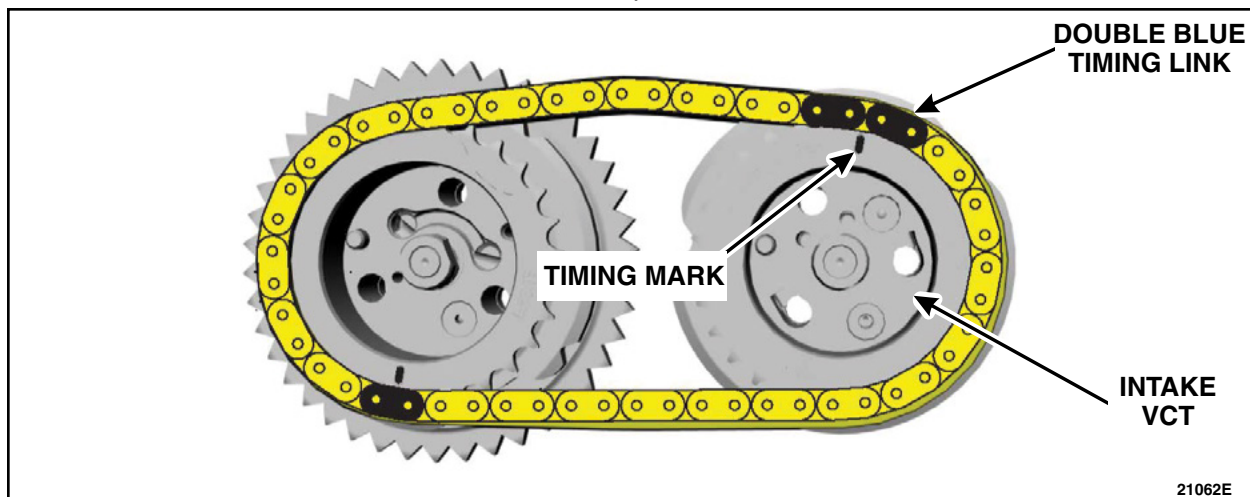

FIGURE 6



4. Remove the spark plugs on the affected side(s). Please follow the WSM procedures in Section 303-07.
5. Perform a Cylinder Leakage Detection Test on the affected side(s). Please follow the WSM procedures in Section 303-00.

Pass - Proceed to Step 7.

Does Not Pass - Proceed to Step 6.

6. Replace both the RH and LH Secondary Timing Chain Tensioner, Secondary Timing Chain Tensioner Shoes/Guides, and the Secondary Timing Chains. On the affected side(s), replace the Pistons, Connecting Rods, Cylinder Head. Please follow the WSM procedures in section 303-01. This completes this recall.
7. Replace both the RH and LH Secondary Timing Chain Tensioner, Secondary Timing Chain Tensioner Shoes/Guides, and the Secondary Timing Chains. On the affected side(s), replace the Cylinder Head. Please follow the WSM procedures in section 303-01. This completes this recall.

IMPORTANT NOTE: Federal law prohibits selling motor vehicle parts or components that are under safety, compliance, or emissions recall. Unless a part is requested to be returned to Ford, all parts replaced under this FSA must be scrapped in accordance with all applicable local, state and federal environmental protection and hazardous material regulations. Refer to the Parts Retention, Return, & Scrapping section of the FSA dealer bulletin for further information.

