

SECTION 502-00: Uni-Body, Subframe and Mounting System
REMOVAL AND INSTALLATION

2013 Mustang Workshop Manual
Procedure revision date: 05/01/2012

Crossmember — Transmission, 5.8L (4V)

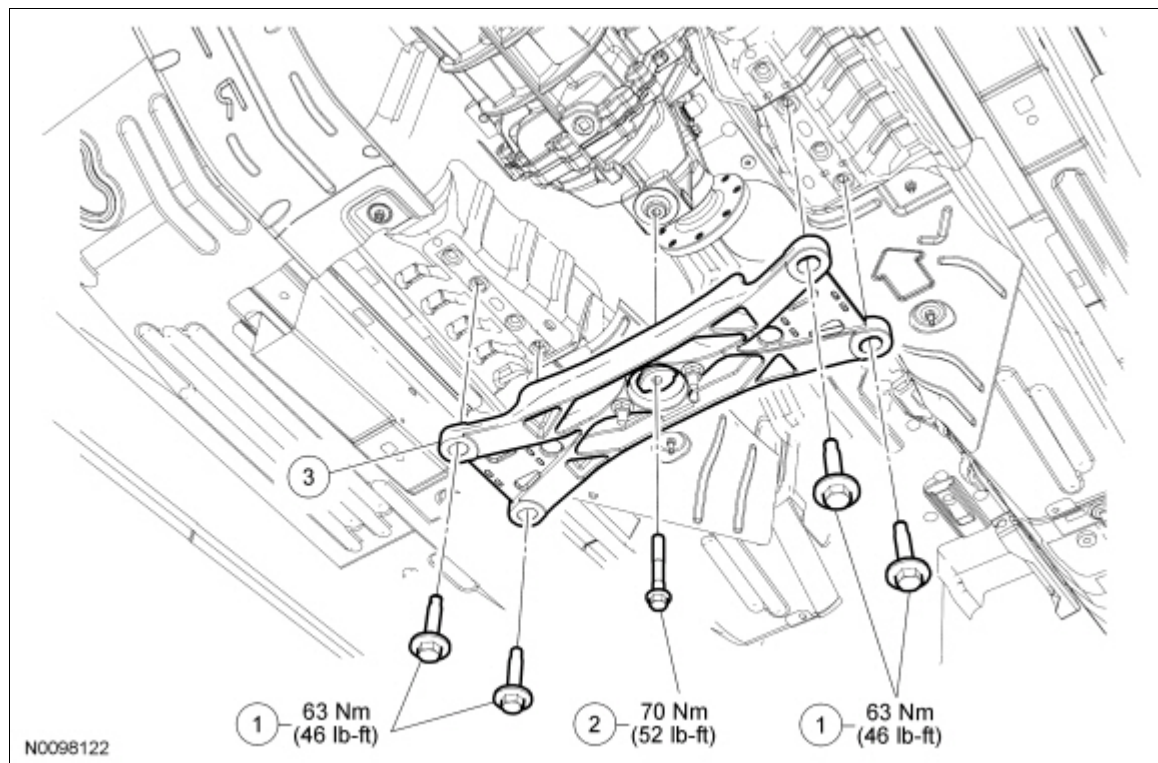

Item	Part Number	Description
1	W505466	Transmission crossmember bolts
2	N804518	Transmission support insulator bolt
3	5060	Transmission crossmember

Removal

NOTICE: The transmission crossmember must be installed in the same orientation as it was removed. An incorrectly installed crossmember will change the driveline angle and cause a shudder when accelerating from a stop or above average engine presence.

1. With the vehicle in NEUTRAL, position it on a hoist. For additional information, refer to [Section 100-02](#).
2. Using a suitable transmission jack, support the transmission.
3. Remove the transmission support insulator bolt.

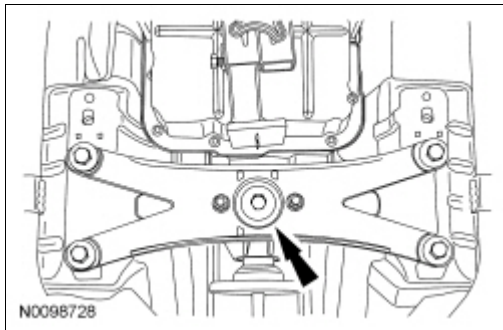

4. Remove the transmission crossmember bolts and remove the transmission crossmember.

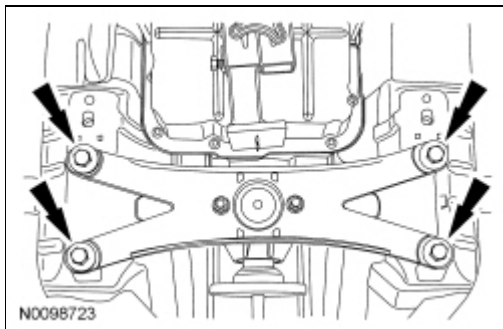

Installation

1. Position the crossmember to the vehicle with the same orientation as when removed.
2. Loosely install the transmission crossmember bolts.

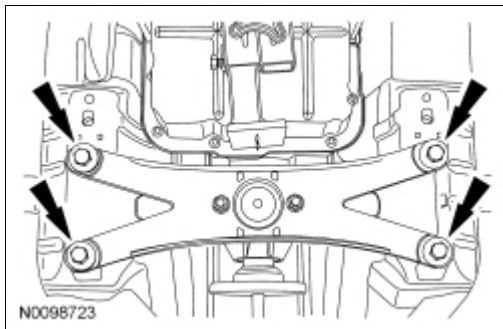

3. Loosely install the transmission support insulator bolt.

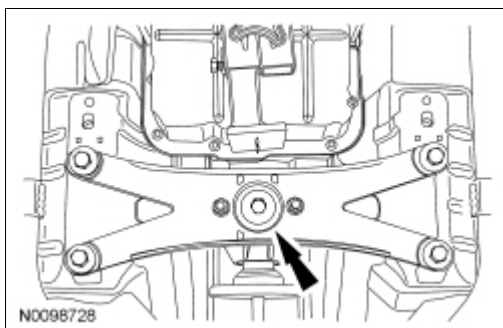

4. **NOTE:** The transmission support insulator must be neutralized.

Slide the transmission crossmember forward, rearward and side-to-side until the gaps between the transmission support insulator and the transmission crossmember are equal.

5. With the transmission support insulator neutralized, tighten the transmission crossmember bolts.
- Tighten to 63 Nm (46 lb-ft).

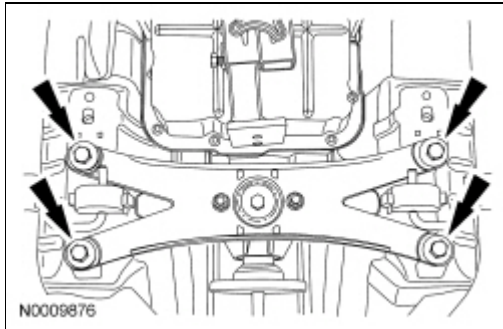

6. With the transmission support insulator neutralized, tighten the transmission support insulator bolt.
- Tighten to 70 Nm (52 lb-ft).

