

Driver Airbag

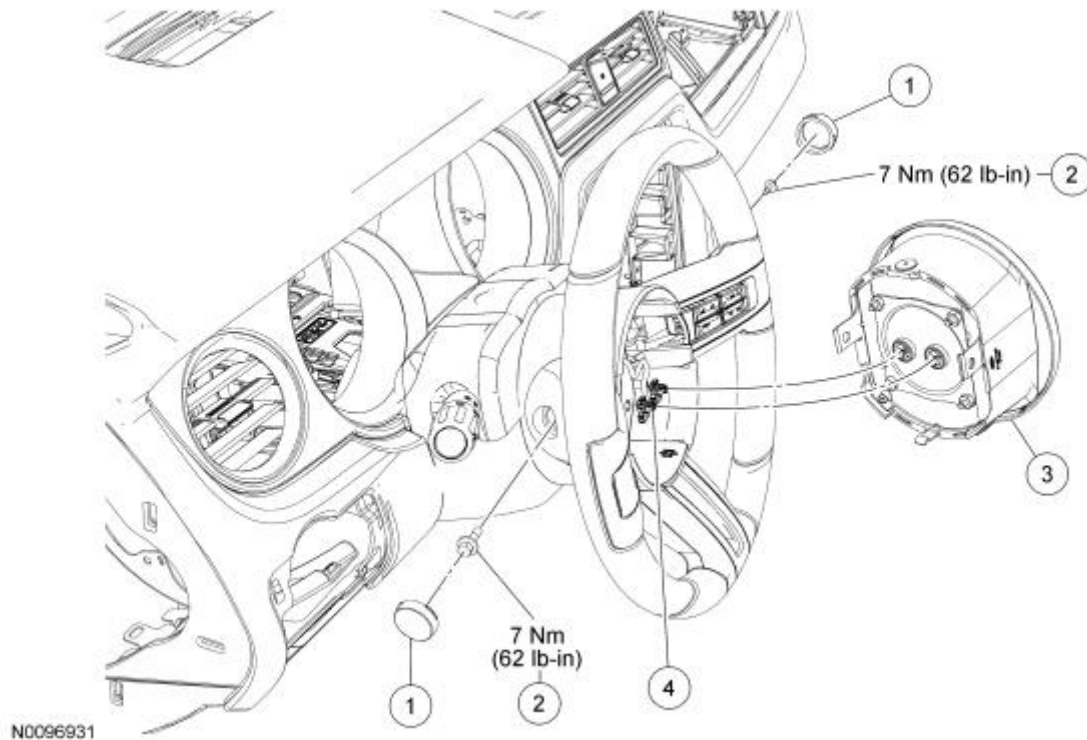

Item	Part Number	Description
1	3L518	Driver air bag module bolt caps (2 required)
2	W506411	Driver air bag module bolts (2 required)
3	043B13	Driver air bag module
4	—	Driver air bag module electrical connectors (part of 14A664)

Removal



WARNING: Always carry a live airbag with the deployment door, trim cover or tear seam pointed away from the body. Do not place a live airbag down with the deployment door, trim cover or tear seam facing down. Failure to follow these instructions may result in serious personal injury in the event of an accidental deployment.



WARNING: Never probe the electrical connectors on airbag, Safety Canopy or side air curtain assemblies. Failure to follow this instruction may result in the accidental deployment of these assemblies, which increases the risk of serious personal injury or death.

NOTE: The air bag warning indicator illuminates when the correct Restraints Control Module (RCM) fuse is removed and the ignition is ON.

NOTE: The Supplemental Restraint System (SRS) must be fully operational and free of faults before releasing the vehicle to the customer.

1. Depower the SRS. For additional information, refer to Supplemental Restraint System (SRS) Depowering and Repowering in the General Procedures portion of this section.
2. Remove the 2 driver air bag module bolt caps.
3. Remove the 2 driver air bag module bolts.
 - To install, tighten to 7 Nm (62 lb-in).
4. Disconnect the 2 driver air bag module electrical connectors and remove the driver air bag module.

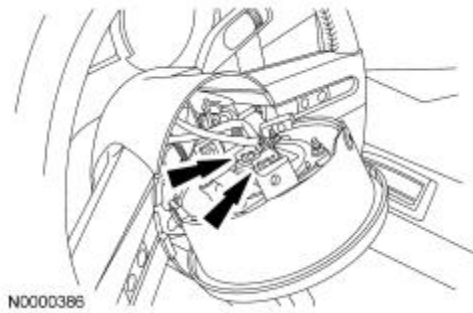

5. To install, reverse the removal procedure.
6. Repower the SRS. For additional information, refer to Supplemental Restraint System (SRS) Depowering and Repowering in the General Procedures portion of this section.

Supplemental Restraint System (SRS) Deactivation and Reactivation

Special Tool(s)



Vehicle Communication Module (VCM) and Integrated Diagnostic System (IDS) software with appropriate hardware, or equivalent scan tool

Deactivation



WARNING: Wear eye and ear protection when servicing a vehicle. Failure to follow this instruction may result in serious personal injury.

NOTE: The air bag warning indicator illuminates when the correct Restraints Control Module (RCM) fuse is removed and the ignition is ON.

NOTE: The Supplemental Restraint System (SRS) must be fully operational and free of faults before releasing the vehicle to the customer.

1. Turn all vehicle accessories OFF.
2. Turn the ignition to OFF.
3. At the Smart Junction Box (SJB), located in the RH lower kick panel, remove the cover and the RCM fuse 31 (10A) from the SJB. For additional information, refer to the Wiring Diagrams manual.
4. Turn the ignition ON and monitor the air bag warning indicator for at least 30 seconds. The air bag warning indicator will remain lit continuously (no flashing) if the correct RCM fuse has been removed. If the air bag warning indicator does not remain lit continuously, remove the correct RCM fuse before proceeding.
5. Turn the ignition OFF.

6.  **WARNING:** Always deplete the backup power supply before repairing or installing any new front or side air bag supplemental restraint system (SRS) component and before servicing, removing, installing, adjusting or striking components near the front or side impact sensors or the restraints control module (RCM). Nearby components include doors, instrument panel, console, door latches, strikers, seats and hood latches. Refer to the Description and Operation portion of Section 501-20B for location of the RCM and impact sensor(s). To deplete the backup power supply energy, disconnect the battery ground cable and wait at least 1 minute. Be sure to disconnect auxiliary batteries and power supplies (if equipped). Failure to follow these instructions may result in serious personal injury or death in the event of an accidental deployment.

Disconnect the battery ground cable and wait at least one minute. For additional information, refer to Section 414-01.

7. Remove the driver air bag module. For additional information, refer to Driver Airbag in this section.
8. Open and lower the glove compartment door.
9. Disconnect the passenger air bag module electrical connector.

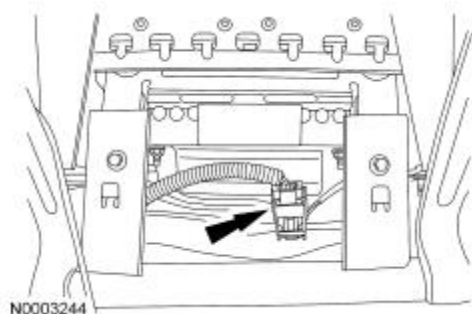

10. Release the locking tab and disconnect the passenger seat side air bag module electrical connector.

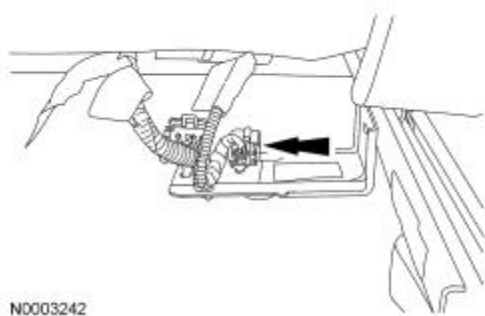

11. Release the locking tab and disconnect the driver seat side air bag module electrical connector.

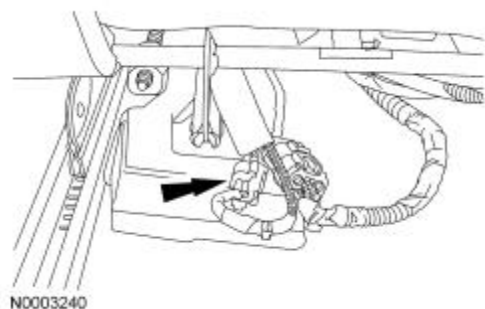

12. Install RCM fuse 31 (10A) to the RCM.
13. Connect the battery ground cable. For additional information, refer to Section 414-01.

Reactivation

1. Remove RCM fuse 31 (10A) from the SJB.
2. Disconnect the battery ground cable and wait at least one minute.
3. Connect the driver seat side air bag module electrical connector and close the red locking tab.

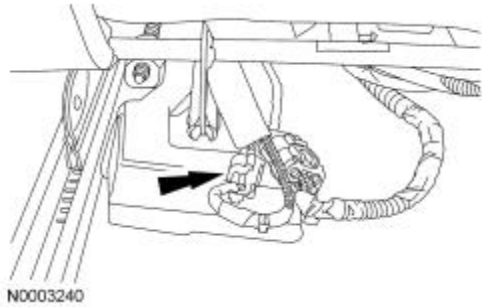

4. Connect the passenger seat side air bag module electrical connector and close the red locking tab.

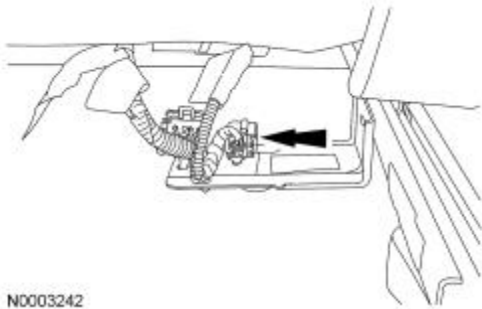

5. Connect the passenger air bag module electrical connector.

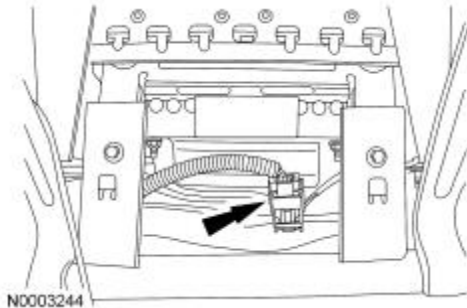

6. Install the driver air bag module. For additional information, refer to Driver Airbag in this section.
7. Turn the ignition from OFF to ON.
8. Install RCM fuse 31 (10A) to the SJB and close the cover.

9.  **WARNING:** Make sure no one is in the vehicle and there is nothing blocking or placed in front of any airbag when the battery is connected. Failure to follow these instructions may result in serious personal injury in the event of an accidental deployment.

Connect the battery ground cable.

10. Prove out the SRS as follows:

Turn the ignition from ON to OFF. Wait 10 seconds, then turn the ignition ON and monitor the air bag warning indicator with the air bag modules installed. The air bag warning indicator will light continuously for approximately 6 seconds and then turn off. If an air bag SRS fault is detected, the air bag warning indicator will:

- fail to light.
- remain lit continuously.
- flash.

The flashing might not occur until approximately 30 seconds after the ignition has been turned from the OFF to the ON position. This is the time required to complete testing of the SRS. If the air bag warning indicator is inoperative and a SRS fault exists, a chime will sound in a pattern of 5 sets of 5 beeps. If this occurs, the air bag warning indicator and any SRS fault discovered must be diagnosed and repaired.

Clear all RCM and Occupant Classification System Module (OCSM) Continuous Memory Diagnostic Trouble Codes (CMDTCs).
