

Lateral Stiffener Bar

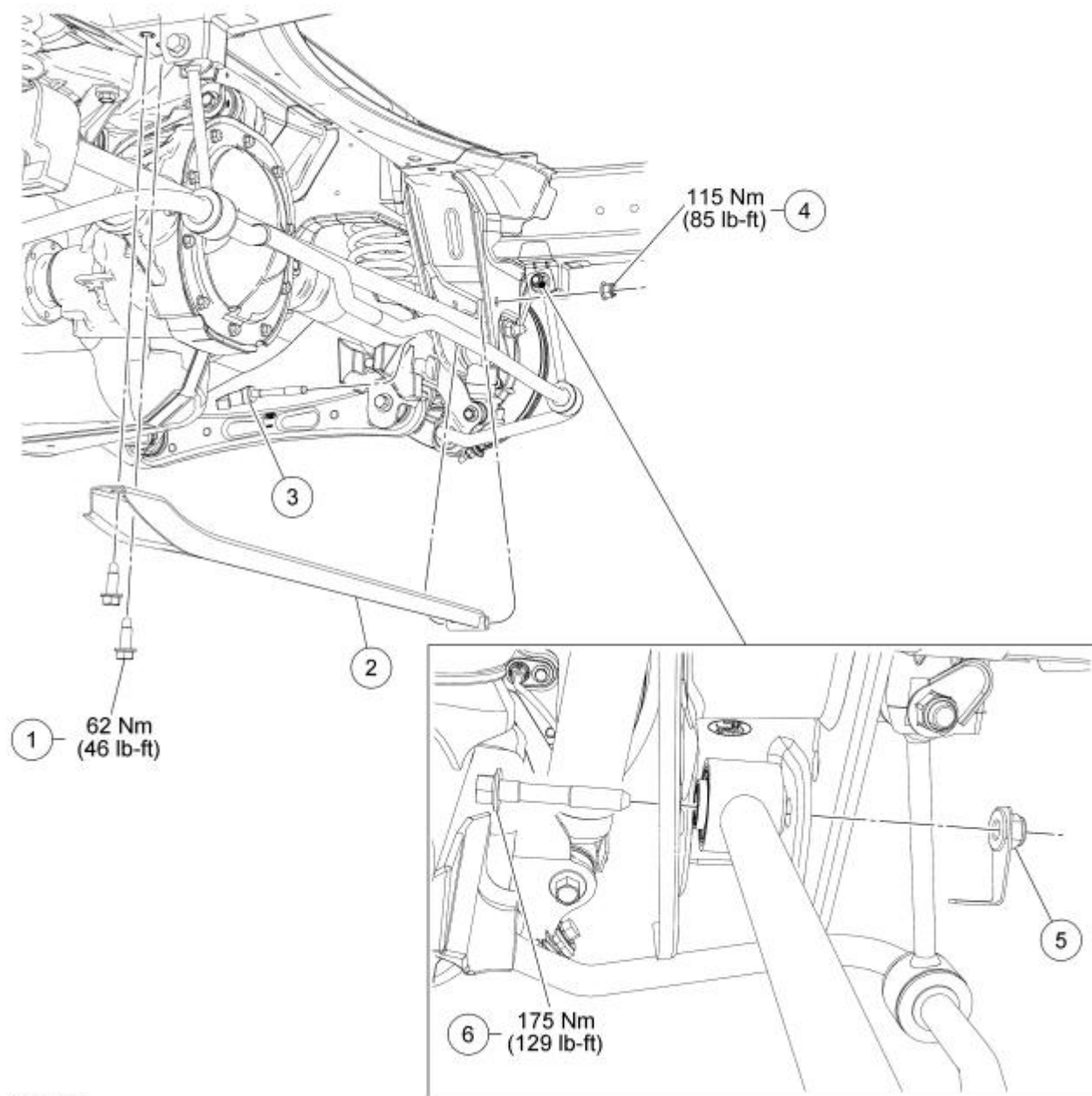

N0072252

Item	Part Number	Description
1	W711331	Lateral stiffener bar-to-body bolt (2 required)
2	3424	Lateral stiffener bar
3	W710693	Lateral stiffener bar flag bolt
4	W520214	Lateral stiffener bar nut
5	W710022	Panhard rod flagnut (RH)
6	W704886	Panhard rod bolt

Removal and Installation

NOTICE: Suspension fasteners are critical parts because they affect performance of vital components and systems and their failure may result in major service expense. New parts must be installed with the same part numbers or equivalent part, if replacement is necessary. Do not use a replacement part of lesser quality or substitute design. Torque values must be used as specified during reassembly to make sure of correct retention of these parts.

1. Mark the rear shock absorber relative to the protective sleeve with the vehicle in a static, level ground position (curb height).

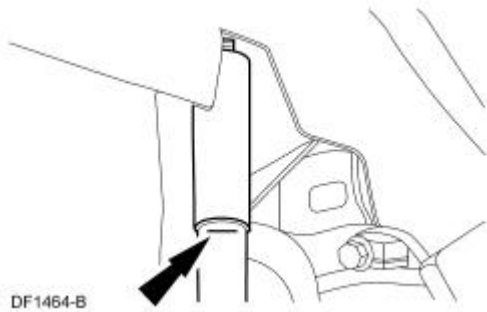

2. With the vehicle in NEUTRAL, position it on a hoist. For additional information, refer to Section 100-02.
3. **NOTICE:** Do not support the rear axle at the differential housing or damage to the housing may occur.
Using 2 suitable jackstands, support the rear axle.
4. Raise the rear axle so the mark made on the rear shock absorber in Step 1 lines up with the protective sleeve.

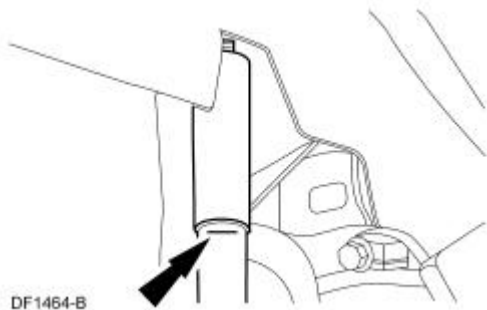

5. Remove and discard the RH panhard rod bolt, then remove and discard the lateral stiffener bar-to-body mount nut and flag bolt.
 - To install:
 - Tighten the new RH panhard rod bolt to 175 Nm (129 lb-ft).
 - Tighten the new lateral stiffener bar-to-body mount nut to 115 Nm (85 lb-ft).

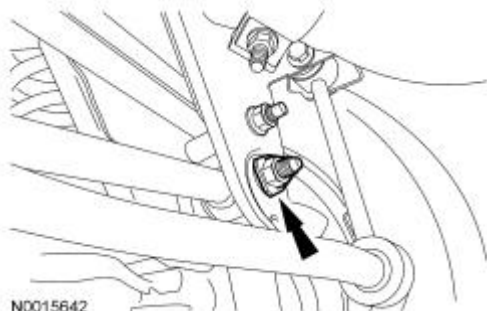

6. Remove and discard the lateral stiffener bar-to-body bolts.
 - To install, tighten the new bolts to 62 Nm (46 lb-ft).

7. Remove the lateral stiffener bar.
8. ***NOTICE:*** Tighten the new RH panhard rod bolt while the suspension is at curb height or bushing damage and incorrect clamp load may occur.

To install, reverse the removal procedure.

Panhard Rod

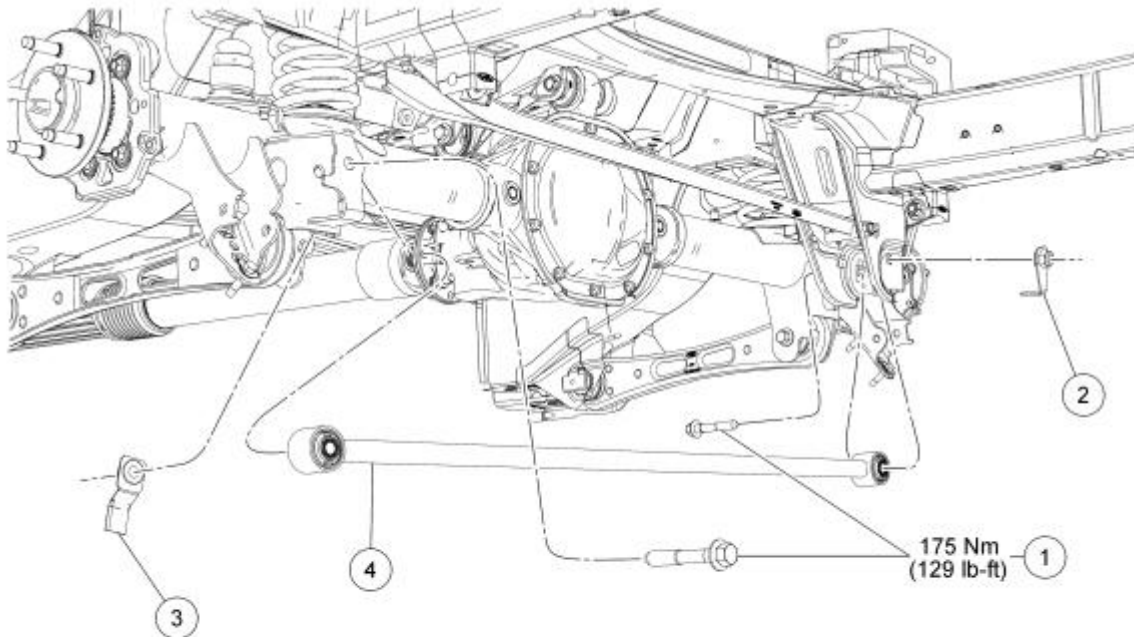

N0072259

Item	Part Number	Description
1	W704886	Panhard rod bolts (2 required)
2	W710022	Panhard rod flange nut (RH)
3	W710689	Panhard rod flange nut (LH)
4	4264	Panhard rod

Removal and Installation

NOTICE: Suspension fasteners are critical parts because they affect performance of vital components and systems and their failure may result in major service expense. New parts must be installed with the same part numbers or equivalent part, if replacement is necessary. Do not use a replacement part of lesser quality or substitute design. Torque values must be used as specified during reassembly to make sure of correct retention of these parts.

1. To aid in installation, mark the rear shock absorber relative to the protective sleeve with the vehicle in a static, level ground position (curb height).

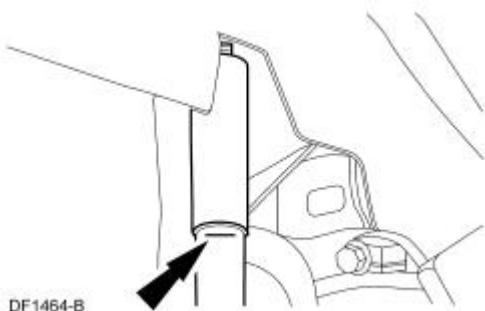

2. With the vehicle in NEUTRAL, position it on a hoist. For additional information, refer to Section 100-02.

3. **NOTICE: Do not support the rear axle at the differential housing or damage to the housing may occur.**

Using 2 suitable jackstands, support the rear axle.

4. Raise the rear axle so the mark made on the rear shock absorber in Step 1 lines up with the protective sleeve.

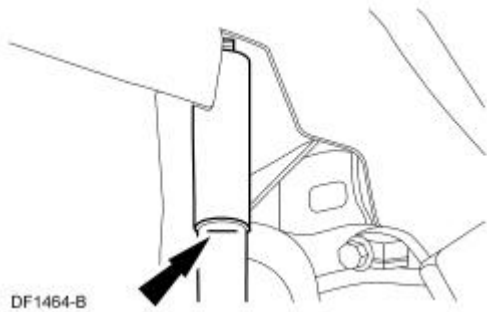

5. Using 2 screwdrivers inserted through the access hole, depress the tabs of the panhard rod bolt cover retaining clip and remove the cover.

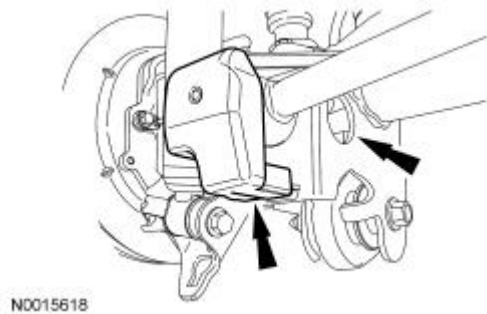

6. Remove and discard the panhard rod bolts and flagnuts.

- To install, tighten the new bolts to 175 Nm (129 lb-ft).

7. **NOTICE: Tighten the LH and RH panhard rod bolts with the suspension at curb height or damage may occur.**

To install, reverse the removal procedure.

Material		
Item	Specification	Fill Capacity
Silicone Spray Lubricant XL-6	ESR-M13P4-A	—

Torque Specifications

Description	Nm	lb-ft	lb-in
Brake caliper anchor plate bolts	103	76	—
Brake hose bracket bolt	20	—	177
Fuel tank strap bolt	52	38	—
Lateral stiffener bar nut	115	85	—
Lateral stiffener bar-to-body bolts	62	46	—
Lower arm bolts	175	129	—
Panhard rod bolts	175	129	—
Parking brake cable bracket bolt	27	20	—
Shock absorber lower bolt	115	85	—
Shock absorber upper nut	40	30	—
Shock absorber upper nut (GT500)	35	26	—
Stabilizer bar bracket nuts	70	52	—
Stabilizer bar link bolts	115	85	—
Upper arm bracket forward bolt	440	325	—
Upper arm bracket rearward bolts	115	85	—
Upper arm-to-upper arm bushing nut	175	129	—